



## 1767 Series All-Attitude Isolators

A compact, mid range frequency , general purpose all-attitude isolator for equipment for aircraft, shipboard and vehicular applications.

### Features

- Fail Safe design, All-Attitude isolator.
- Axial to Radial Stiffness ratio 1:1.
- Compact, low profile design.
- Easy to install.
- High Damped Silicone.
- Isolates equipment under 5G's sustained loading.

### Load Range

- 3 load ratings available up to 20 Lbs.
- Can be custom tailored to specific applications.

### Environmental Shock and Vibe

- Provides excellent vibration attenuation at frequencies above 40 hertz .
- Survives a 30g, 11 millisecond half-sine crash shock pulse.

### Applications

- Military electronics (shipboard, vehicle)
- Electronics for rotary wing and propeller driven aircraft.
- Avionics & electronics
- Racking and tray systems.



The 1767 mount is a mid frequency range all-attitude general purpose isolator for isolating sensitive electronics equipment for shipboard, aircraft and vehicular applications. These isolators are ideal for mounting to racks or trays systems that need a fail safe, high frequency vibration and low transmissibility at resonance isolator.

Part #	Maximum Load (lbs.)		Axial Natural Frequency (HZ)	Standard Material	Standard Elastomer	Transmissibility at Resonance
	Axial Compression	Radial				
1767-1	10	10	22	Steel & Aluminum	Hi-Damp Silicone	4:1
1767-2	15	15	20	Steel & Aluminum	Hi-Damp Silicone	4:1
1767-3	20	20	21	Steel & Aluminum	Hi-Damp Silicone	4:1

### Environmental data

Hi-Damp Silicone operating temperature range is -67°F to +300°F (-55°C to +150°C)  
 Passes Mil-E-5400 requirement for ozone, humidity, salt spray and fungus  
 Passes Mil-S-901 lightweight Grade B high impact shock test.

**Engineered Plastics Solutions Group, Inc**  
 22 Thompson Road  
 Norwood, MA 02062

**Phone: (781)-762-3913**  
**Fax: (781)-762-5101**  
**Email: [info@epsginc.com](mailto:info@epsginc.com)**

# 1767 Mount Dimensions & Load Deflection Curves

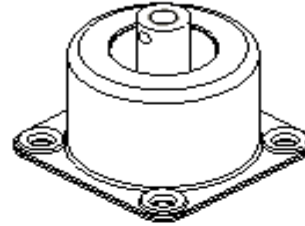
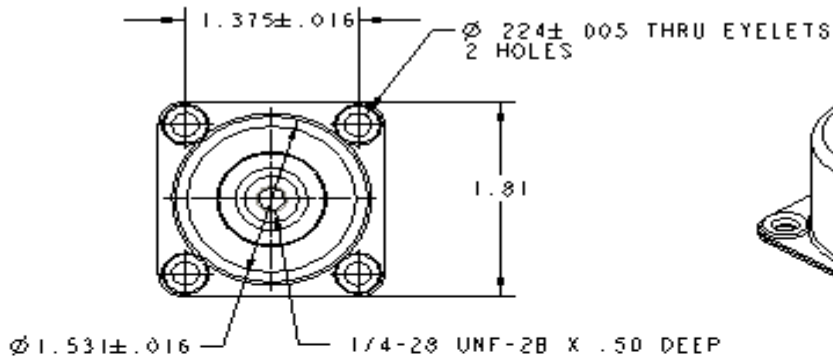

SCALE 1.000

1767 "H" DIMENSION	
COMPRESSED	1.19
APPROX. FREE	1.50
MAX. EXTENDED	1.88

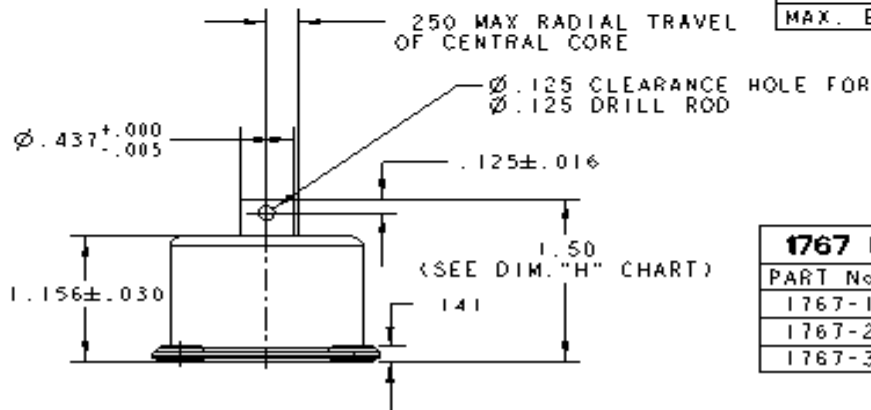

1767 LOAD RANGE DATA	
PART No.	MAX. LOAD/ISOLATOR
1767-1	10 LBS
1767-2	15 LBS
1767-3	20 LBS

Axial Load Deflection Curve for 1767

